

Automatic Screw Feeder

Automatic general purpose screw feeder catalog

Japan quality, sold and trusted in more than 30 countries worldwide!



Model diagrams

NJ / NJL -type

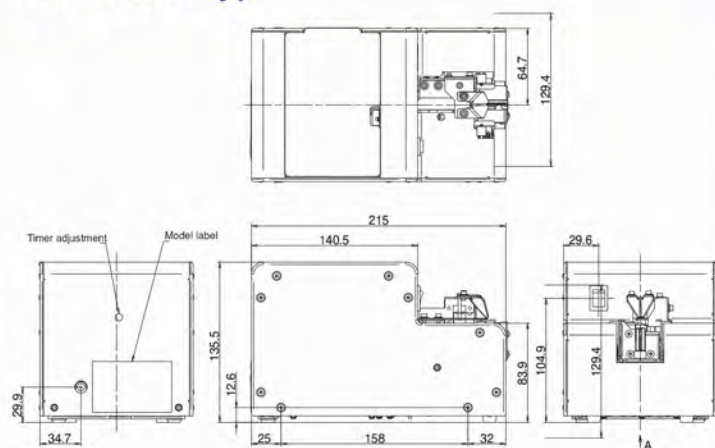

NJR / NJRL -type

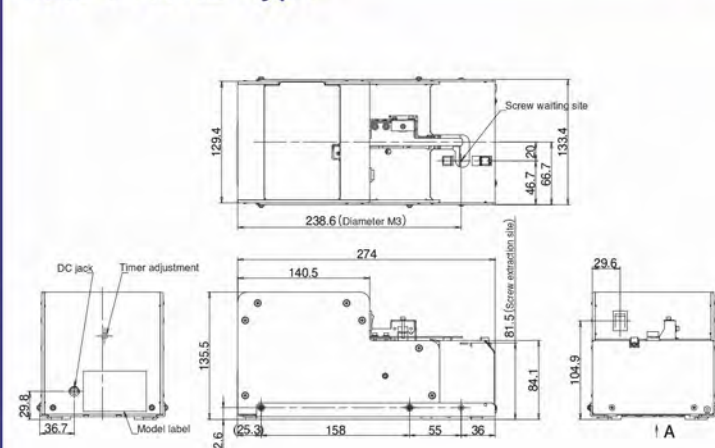

NSR -type

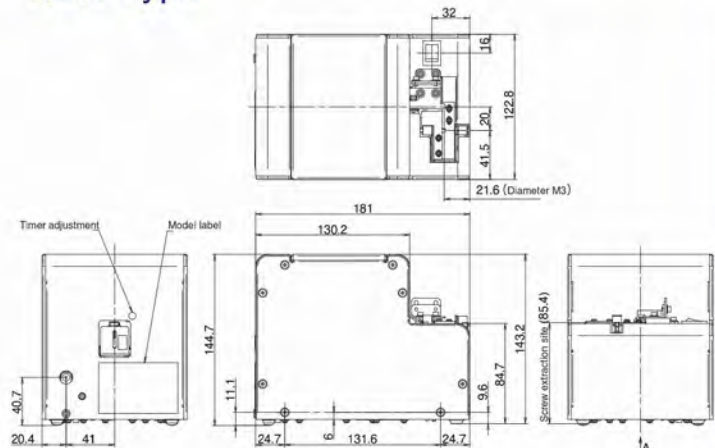

NSRI -type

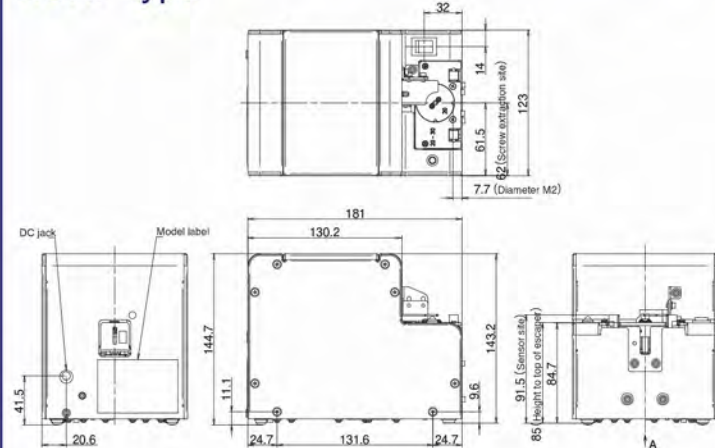

NEJIKURA NJ-80

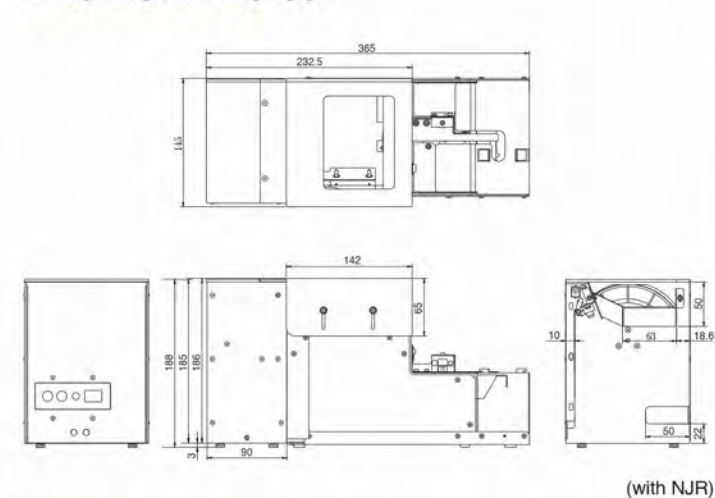

NEJIKURA T-510 S

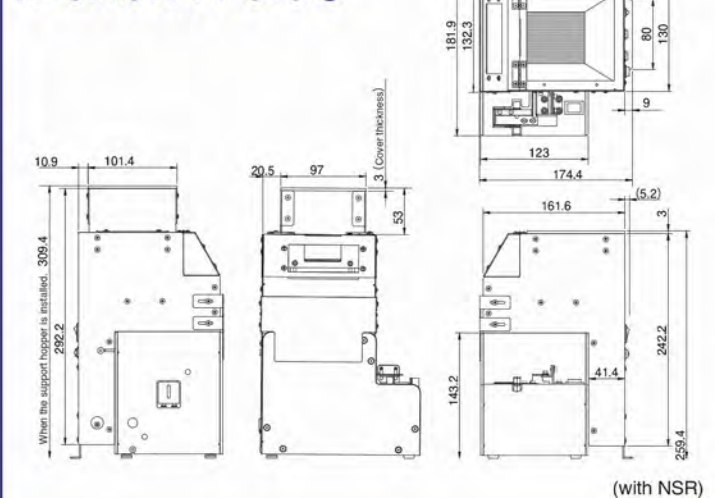

"Quicher" is a registered trademark of OHTAKE-ROOT KOGYO CO.,LTD.

Caution

- The specification and performance values, in this catalog, are based on design calculations, factory tests, individual performance evaluations, results from product use, as well as official specifications. These values are useful for determining the type of machine required for various working conditions.
- The specifications, described in this catalog, may be changed without notice, whenever there are amendments, improvements or changes in the design.
- It is the user's responsibility, when operating this machine in conditions other than recommended or in unusual situations, to contact us for advice, verification or evaluation.
- For your safety, please read the instruction manual before operating this machine.

Contact

www.ohtake-root.co.jp

株式会社 大武・ルート工業

岩手県一関市萩荘字金ヶ崎27 〒021-0902
Tel 0191-24-3144
Fax 0191-24-3145

OHTAKE-ROOT KOGYO CO.,LTD.

27 Kanegasaki Hagisho Ichinoseki
Iwate, 021-0902 JAPAN
Tel +81-191-24-3144
Fax +81-191-24-3145

Japan Quality since 1968

OHTAKE- ROOT KOGYO CO., LTD (Ichinoseki, Iwate, JPN) is an authorized manufacturer of medical equipment. In keeping with its proud tradition of Japan quality, these screw feeders are produced in the same factory that is authorized to manufacture medical equipment and have sold up to 20,000 units per year in 30 countries worldwide. These durable feeders can be adapted to accept various types of screws and are easy to maintain.

Global standards quality!

Three reasons why OHTAKE's automatic screw feeders are popular.

Space-saving!

- Compact and easy to install.
- Portable and adapts easily to various production demands.

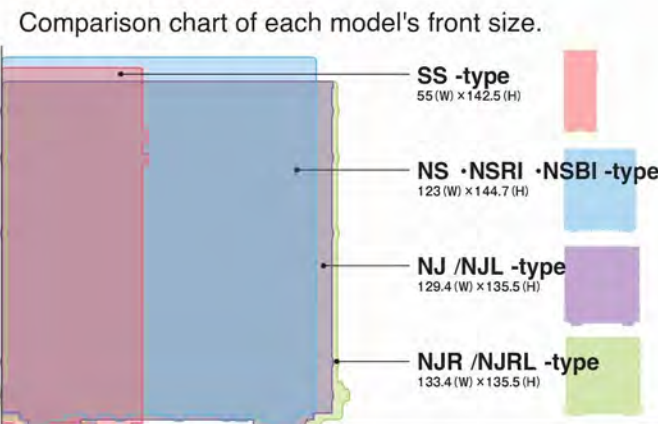

Easy to use!

- Easy to operate, even for beginners.
- When changing the screw type, simply change the rail.
- Pick-up rate of up to two screws per second makes work efficient and productive.

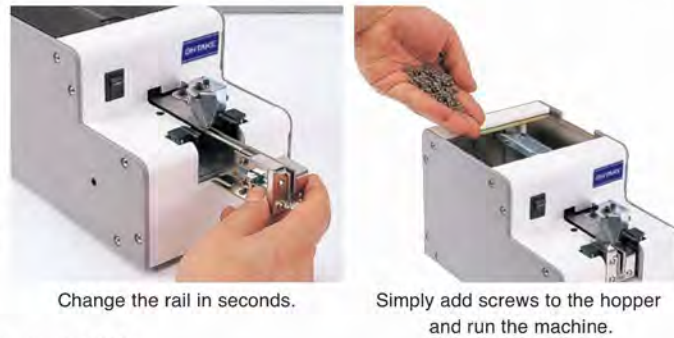

Versatile!

- Standard market screwdriver bits can be used.
- Corresponds with plain washer and spring washer screws.
- Corresponds with various screw types saving installation costs.



Uses standard market bits.

Standards table for choosing models

		M1	M1.2	M1.4	M1.7	M2.0	M2.3	M2.6	M3	M3.5	M4	M5	M6	Length excl. head	Capacity CC
Manual type	NJ					○	○	○	○	○	○	○	△	18mm	150
	NSB	○	○	○	○	○	○	○	○	△	△			20mm	80
	SS	○	○	○	○	○	○	○	○					16mm	40
	NSBI	○	○	○	○	○	○	○	○					20mm	80
Robotic type	NJR			○	○	○	○	○	○	○	○	○	△	18mm	150
	NSR	○	○	○	○	○	○	○	○	△	△			20mm	80
	NSRI	○	○	○	○	○	○	○	○					20mm	80
Manual/Robotic type	NJL					○	○	○	○	○	○	○		25mm	150
	NJRL					○	○	○	○	○	○	○		25mm	150

△...Special orders

Model features and specifications.

General purpose screw feeder NJ -series.

Manual / NJ -type Robotic / NJR -type

Corresponds with larger screws than the NS series. Also a larger capacity hopper makes it more time-efficient.



Robotic-type pick-up (NJR).

3 models with number of corresponding rails (screw sizes in mm).

- NJ -23: 4 rails (2.0 / 2.3 / 2.6 / 3.0)
- NJ -45: 3 rails (3.5 / 4.0 / 5.0)

Hopper capacity: 150cc (approx. 400 standard-sized screws - M3,L12).

Use only 1 screw to replace rails.

Corresponds with screws up to M5.

Horizontal sliding type extracting site (NJR).

Multi-type screw feeder NS -series.

Manual / NSB · NSBI -type Robotic / NSR · NSRI -type

One machine can be adapted to various types of screws by simply changing the rail to match the type.



Manual and robotic model with number of corresponding rails (screw sizes in mm).

- 8 rails (1.0 / 1.2 / 1.4 / 1.7 / 2.0 / 2.3 / 2.6 / 3.0)
- Special order: 3 rails (0.8 / 3.5 / 4.0)

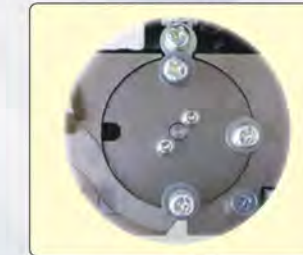

Hopper capacity: 80cc (approx. 210 standard-sized screws M3,L12).

Screw length: up to 20mm (excl. head)

Can be equipped with a NEJIKURA external hopper.

Reduced body size: The depth is 181mm.

Rotating type extracting site (NSBI / NSRI)

General purpose screw feeder NJL -series.

Manual / NJL -type Robotic / NJRL -type

Corresponds with screws up to 25mm long (excl. head).



2 models with number of corresponding rails (screw sizes in mm)

- NJL -23: 4 rails (2.0 / 2.3 / 2.6 / 3.0)
- NJL -45: 3 rails (3.5 / 4.0 / 5.0)

Hopper capacity: 150cc (approx. 400 standard-sized screws - M3,L12).

Use only 1 screw to replace the rail.

Screw length: up to 25 mm (excl. head)

Can be equipped with a NEJIKURA external hopper.

Horizontal sliding type of extracting site (NJRL)

Hopper NEJIKURA

Floor-type / Tower-type

The optional NEJIKURA external hopper and sensor increases the capacity of the screw feeder and supplies the optimum number of screws automatically.



Floor-type



Tower-type

Floor-type

Hopper capacity: 800cc

Screw length: up to 25mm (excl. head)

Tower-type

Hopper capacity: 400cc

With support stocker : increase to 800cc

Screw length: up to 25mm (excl. head)